



DIVISION SCOLAIRE

LOUIS RIEL

SCHOOL DIVISION

# A Second School in Sage Creek

École Sage Creek School  
English Program Families

# Proposed Temporary Solution for the English Program in Sage Creek: Grades 7-8

**2020-2021**  
**2021-2022**



Grade 5 and 6 English Program students living in Sage Creek attend Shamrock School

**2022-2023**



Grade 5, 6, 7 English Program students living in Sage Creek attend Shamrock School

**2023-2024**



Grade 5, 6, 7, 8 English Program students living in Sage Creek attend Shamrock

# Proposed Solution: English Program Students Living in Sage Creek: Grades 9 to 12

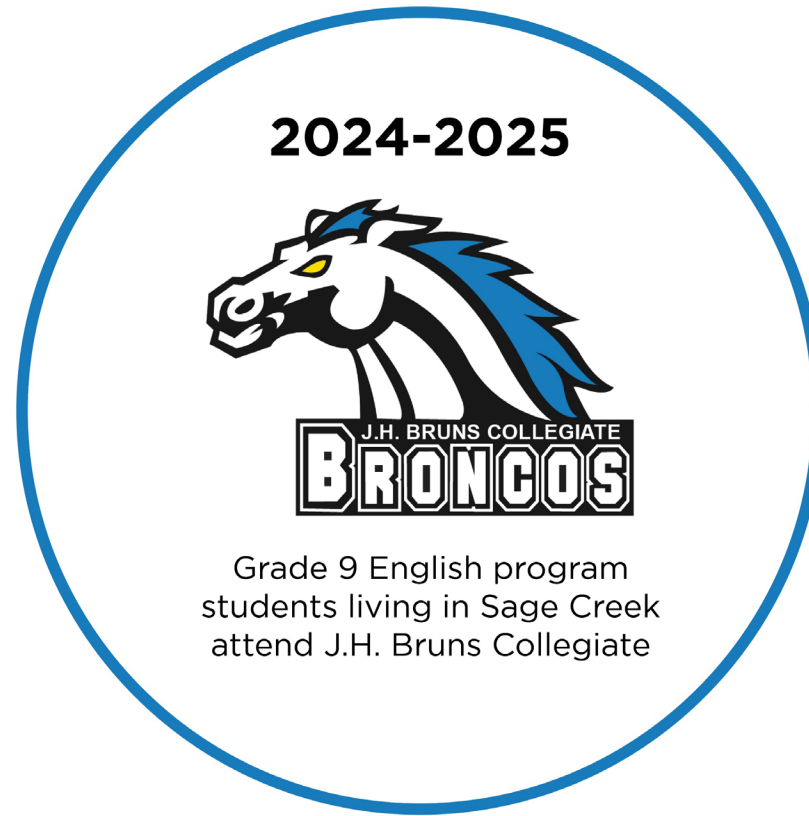



Future Reality:  
Two Schools in  
Sage Creek by  
2025-2026

English Program students (K-8) will attend the  
existing school built for 600 students

# English Program Enrolment Projection

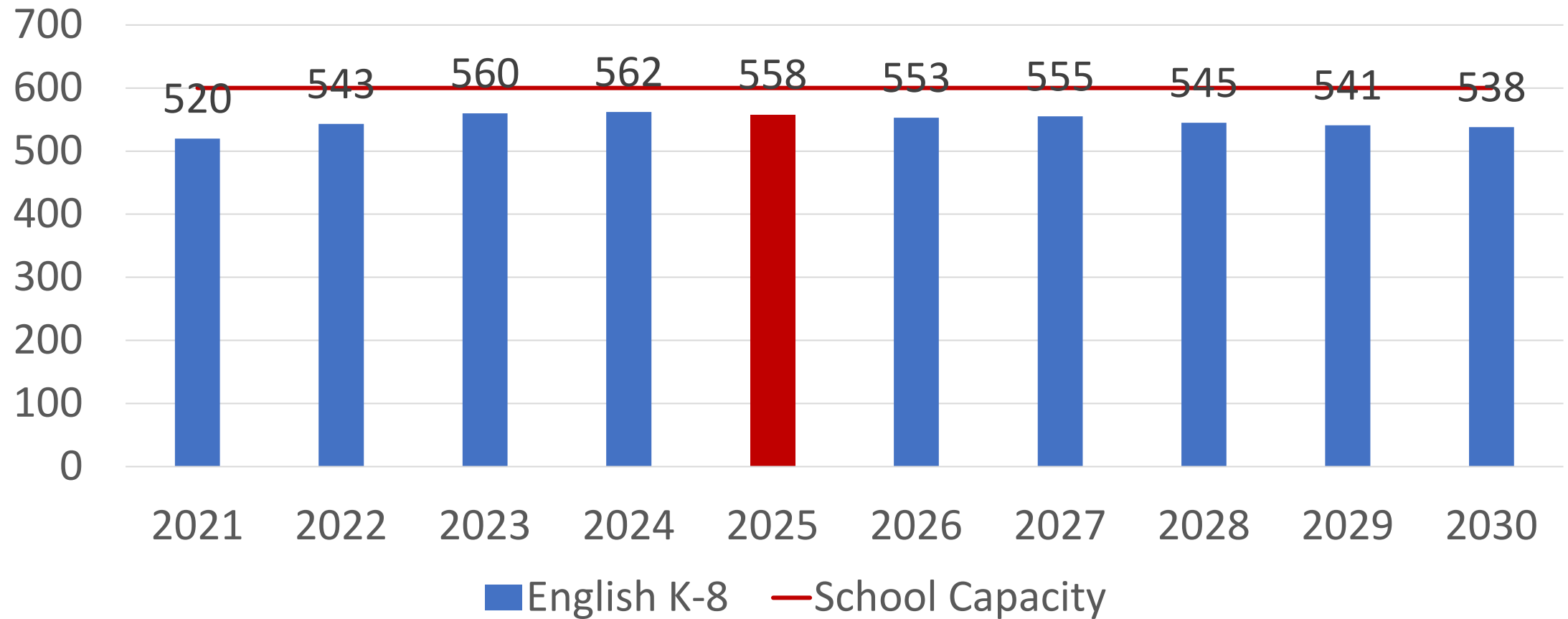

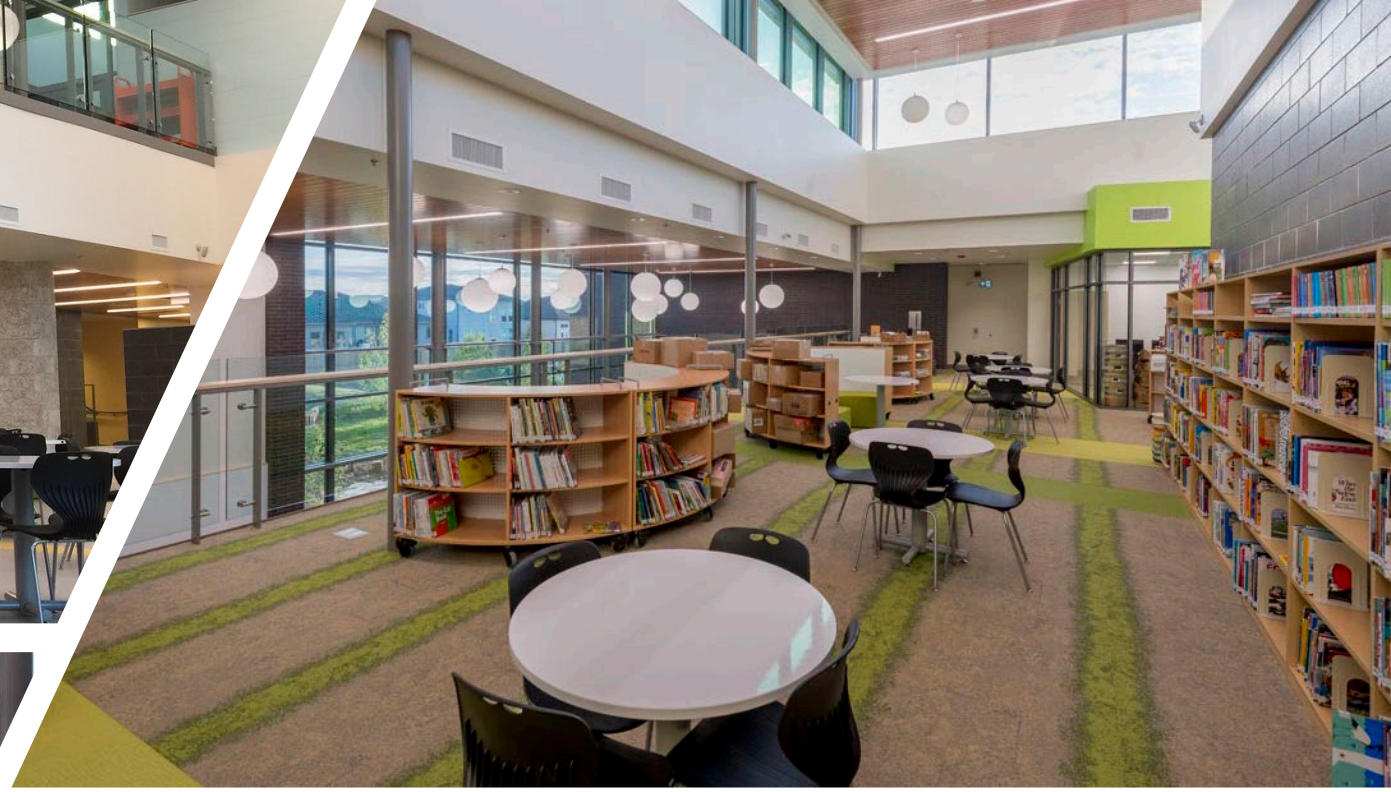



# Two Schools in Sage Creek by 2025-2026

French Immersion program students will attend the new school built for 850 students.

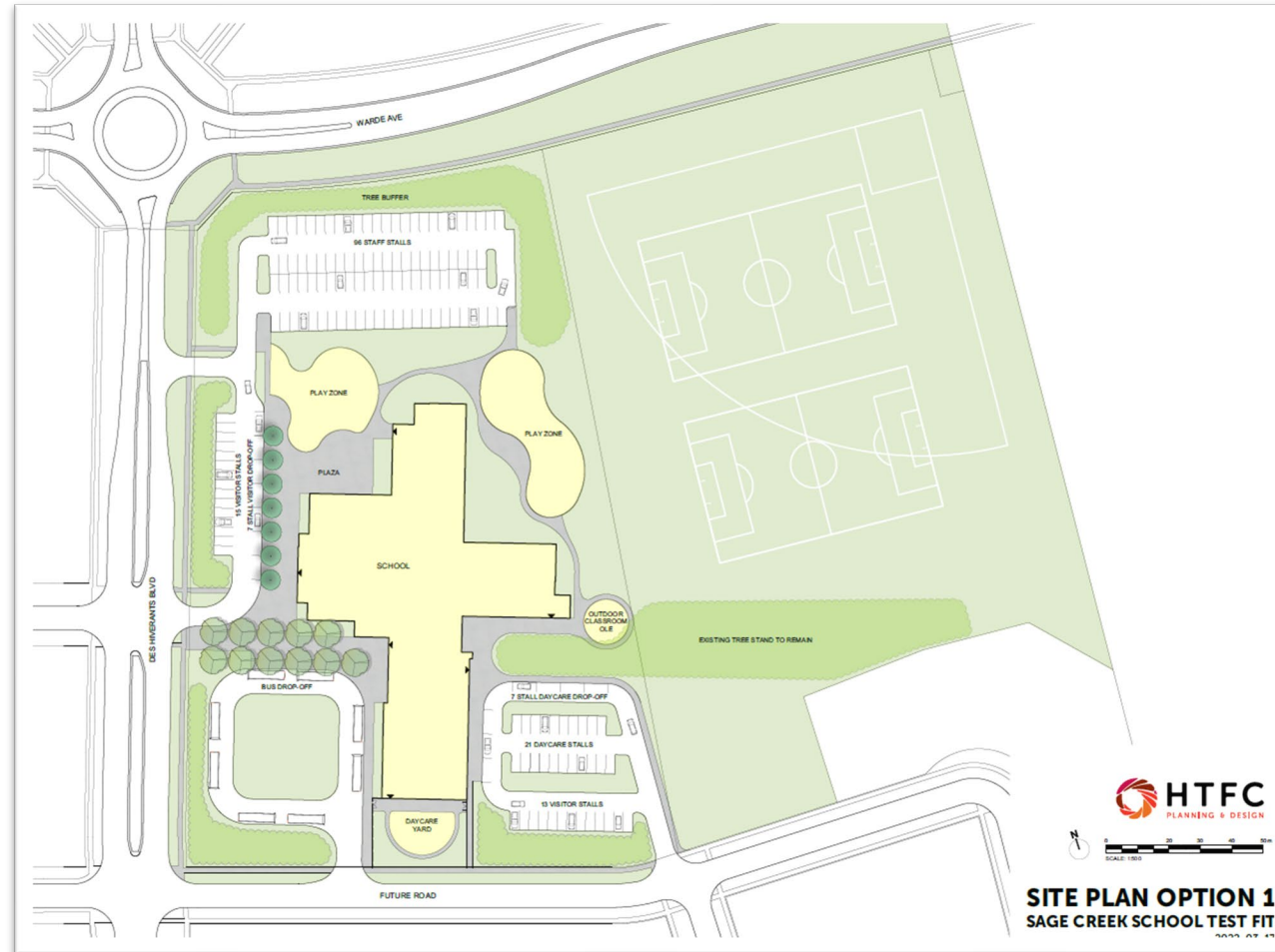



# Location of the New School



Existing School

New School



# Growth of French Immersion

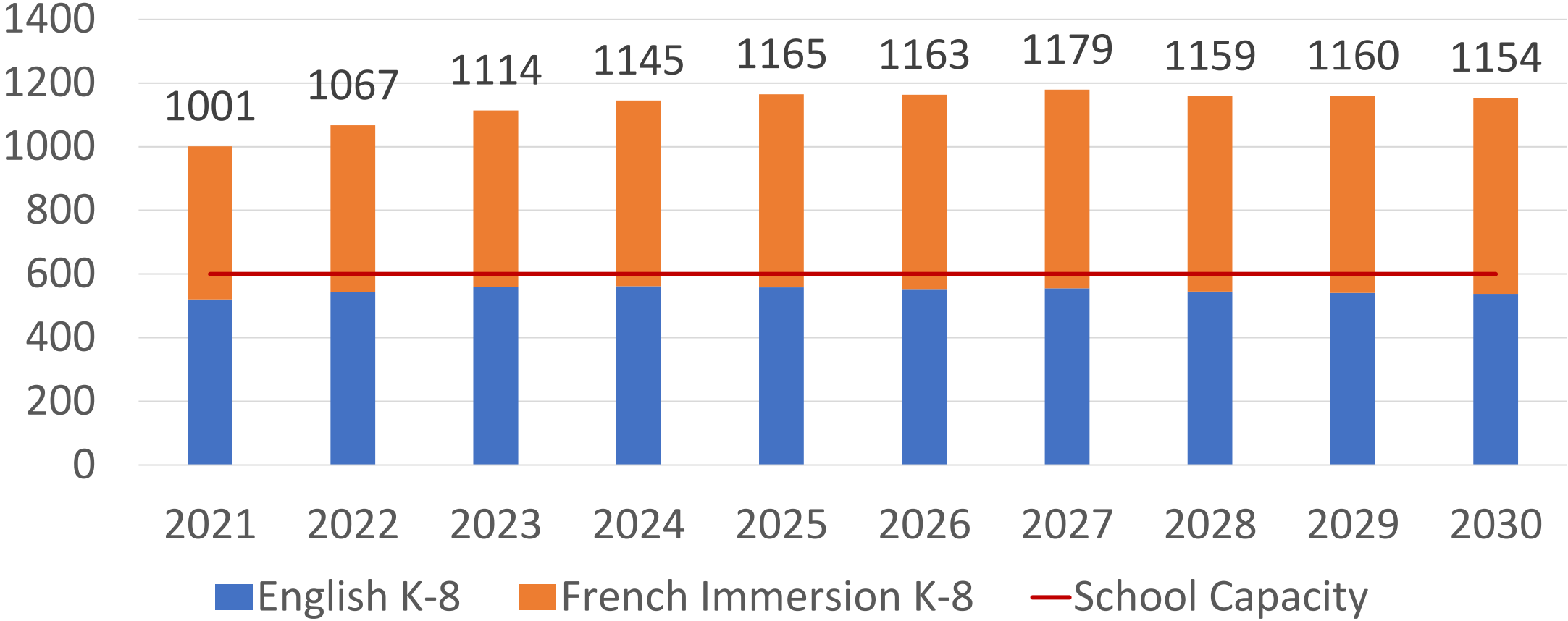

# French Immersion Projection

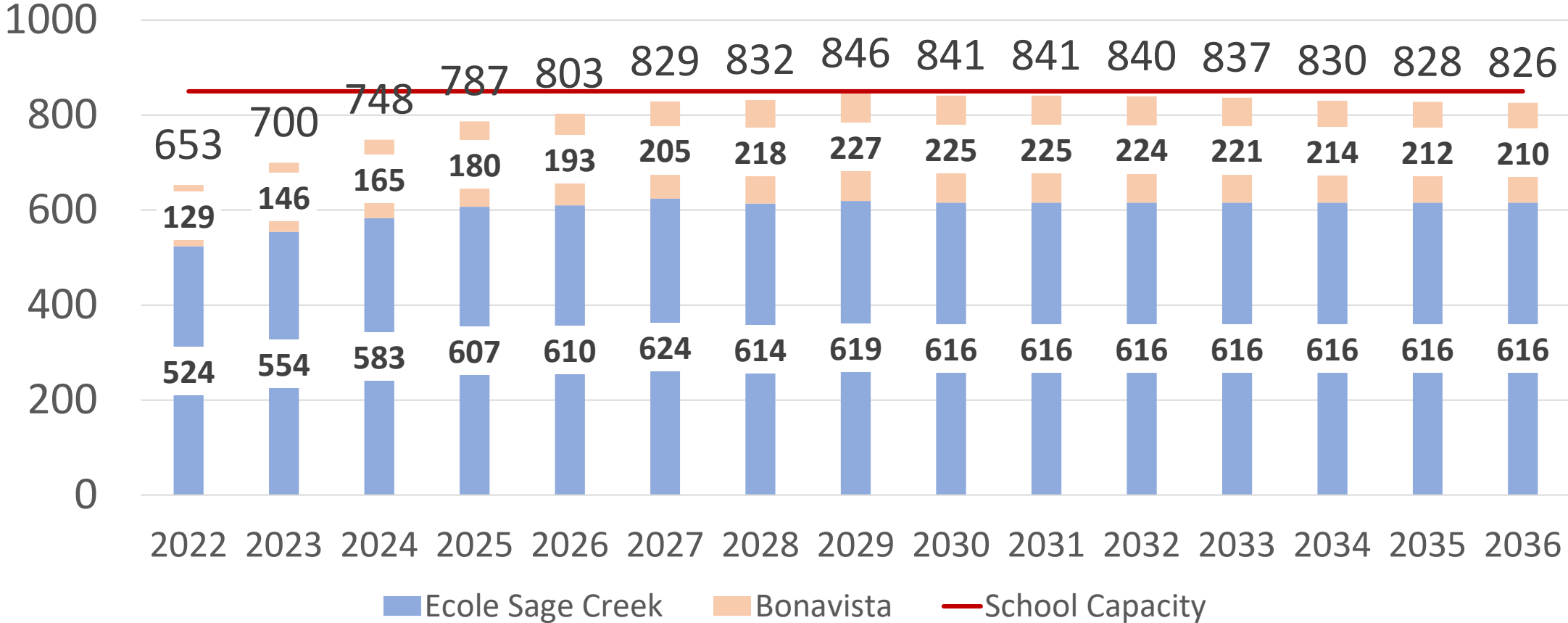

# Our Journey So Far

TIMELINE	MANITOBA GOVT.	DIVISION	DEVELOPER
December 3, 2020	Authorization Letter for Acquisition of Property – New Sage Creek School		
February 1, 2021		Appraisal of approximately 6.0 Acres of Vacant Development Lands	
February 10, 2021		Phase 1 Environment Site Assessment	
February 25, 2021		Signed Letter of Intent	Signed Letter of Intent
May 2021		Signed Land Purchase Agreement	Signed Land Purchase Agreement
April 2021			Development and Rezoning Application
April 2022			Site Development – in progress
April 2022	Program Data Sheet		
May 2022		Submitted Program Data Sheet	



# Next Steps

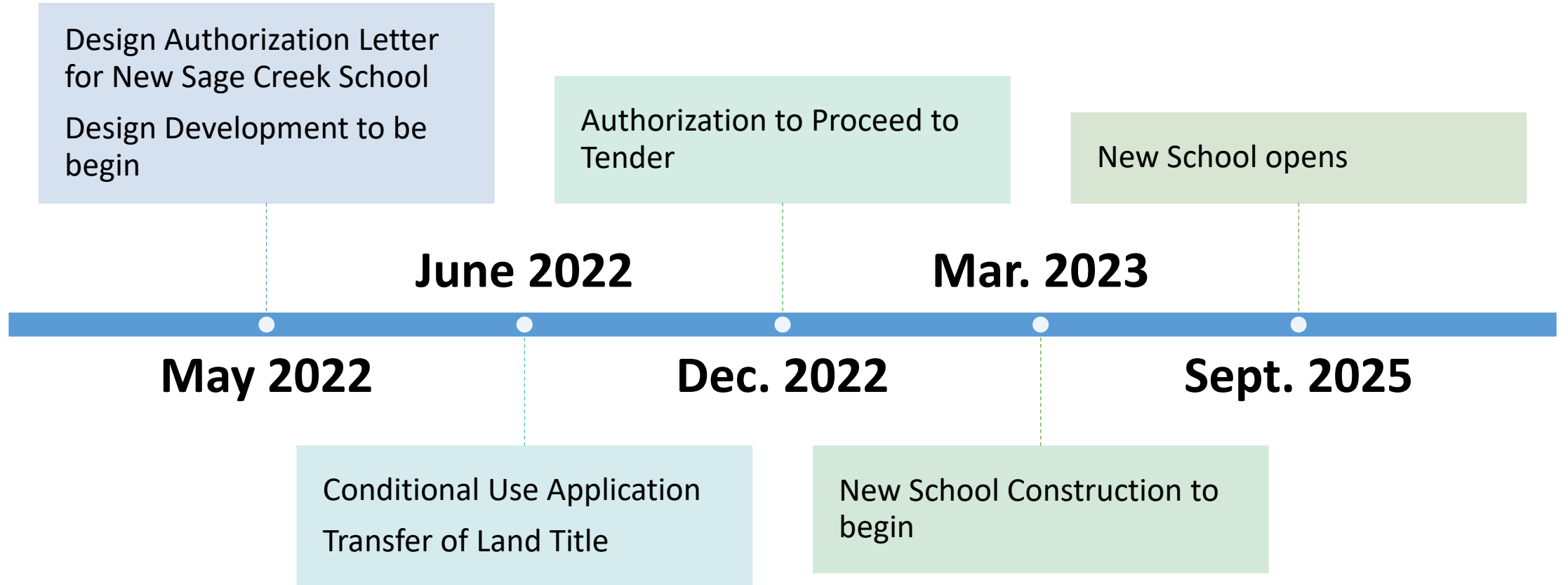



# Your Questions

- When would the new school be ready for students to attend?
- If this “new school” is not in fact ready for when they hope, what is the next course of action. Also, where do the children go for 7/8 and where would they attend high school? What programs are at each of the high schools?
- If Sage Creek students are going to Shamrock why would they split them up for another transition to go to WPC? Why wouldn't they stay with their new friends that they've had to make during a transition instead of transitioning yet again to a whole team of students they don't know while their new cohorts go elsewhere?
- When the new school is built will kids who are attending Shamrock be allowed to come back and join the new school? Will the new school be k-8?

Questions?





Additional  
questions or  
comments?  
Share your  
thoughts through  
our Exit Survey





END OF PRESENTATION